

Modern downlight luminaire for LED light sources for plaster board ceilings.

<b>TECHNICAL DATA</b>	<b>Mounting:</b> in the ceiling, with mounting brackets (included) <b>Body:</b> powder painted steel sheet and anodized aluminum <b>Colour:</b> white, black
<b>ELECTRICAL DATA</b>	<b>Power:</b> 220-240V 50/60Hz <b>Includes light source:</b> yes <b>Type of equipment:</b> ED
<b>OPTICAL DATA</b>	<b>Way of lighting:</b> direct
<b>ADDITIONAL INFO</b>	<b>Available on request:</b> metal halide lamps (on request), DALI <b>Other remarks:</b> for metal halide version - please order MH light sources
<b>GENERAL DATA</b>	<b>Warranty:</b> 3 years + 2 years after project registration <b>Application:</b> hotels, offices, delicatessen, galleries, boutiques, shopping centers



Code	Beam angle	Power LED [W]	Luminaire power [W]	Lumen LED [lm]	Lumen luminaire [lm]	Efficacy [lm/W]	Colour temperature [K]	CRI/Ra
22002X.5L301.3X6	24°	3x17,5	62	3x1560	4680	75	4000	92
22002X.5L302.3X6	24°	3x17,5	62	3x1430	4290	69	3000	92
22002X.5L303.3X6	40°	3x17,5	62	3x1560	4680	75	4000	92
22002X.5L304.3X6	40°	3x17,5	62	3x1430	4290	69	3000	92

22002 .5L.101.3 1

Colour of decorative elements

1	pink
2	red
3	green
4	blue
5	yellow
6	white
7	black

Body colour

1	white
3	black

Code	Dimensions [mm] L W H	Pallet quantity	Quantity in package	Net weight [kg]
22002X.5L301.3X6	348 348 144	30	1	4.6
22002X.5L302.3X6	348 348 144	30	1	4.6
22002X.5L303.3X6	348 348 144	30	1	4.6
22002X.5L304.3X6	348 348 144	30	1	4.6

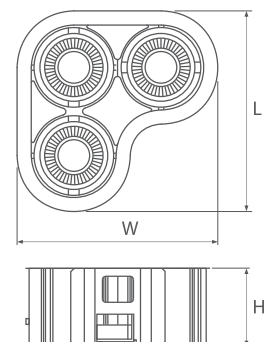

Designed by LUG Design Team

Luminous flux tolerance +/- 10%.

Lighting beam, light intensity distribution and light efficiency were examined in accordance with the EN ISO 17025:2005 norm for EN13032 norm series and the LM-79 norm.

Up-to-date product info available on our website [www.flashdq.com](http://www.flashdq.com)

Date of issue: 26-2-2016

The LUG Company reserves right to introduce any construction changes and improvements into the lighting luminaires

## LIGHT BEAM CURVES

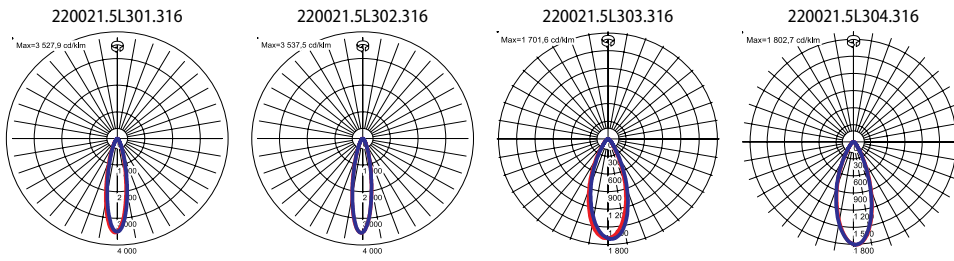

Designed by LUG Design Team

Luminous flux tolerance +/- 10%.

Lighting beam, light intensity distribution and light efficiency were examined in accordance with the EN ISO 17025:2005 norm for EN13032 norm series and the LM-79 norm.

Up-to-date product info available on our website [www.flashdq.com](http://www.flashdq.com)

Date of issue: 26-2-2016

The LUG Company reserves right to introduce any construction changes and improvements into the lighting luminaires